



## Operations Memorandum

**To:** CVG Airlines and Tenants  
**Subject:** Terminal Bridge & Parking Garage Drainage Project  
**Date:** 1/6/2022

Beginning Tuesday, January 10<sup>th</sup>, work will begin on the Terminal Bridge & Parking Garage Drainage Project to replace the cast-iron drainage piping which resides over the baggage claim level curbside and in the Terminal Parking Garage.

**The work under the Terminal bridge, which will impact the baggage claim level curbside, is scheduled in 8 phases which are currently scheduled from 1/10/2023 to 2/15/2023. These phases will begin at the western end of the curbside and move east as they progress. Please know that the currently scheduled timeline is subject to change as the project necessitates.**

Phase 1 is scheduled from 1/10/2023 to 1/13/23 and will occur at the West end of the drive lanes near the baggage claim curbside. During this phase, North bound drive lanes will be open each morning from 0100-0900 and traffic will be closed to the inner curb lanes of the Terminal building at that time.

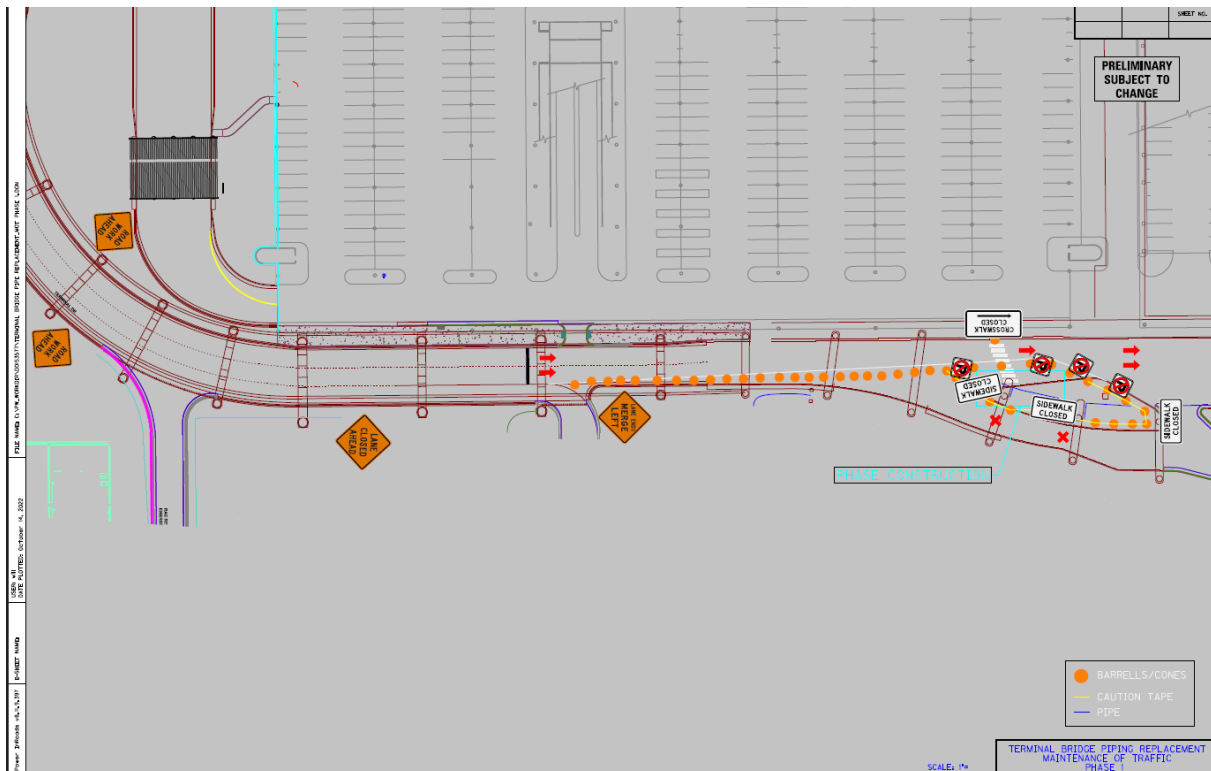

Phase 2 is scheduled to occur between 1/17/23 and 1/19/23 in the area detailed below:

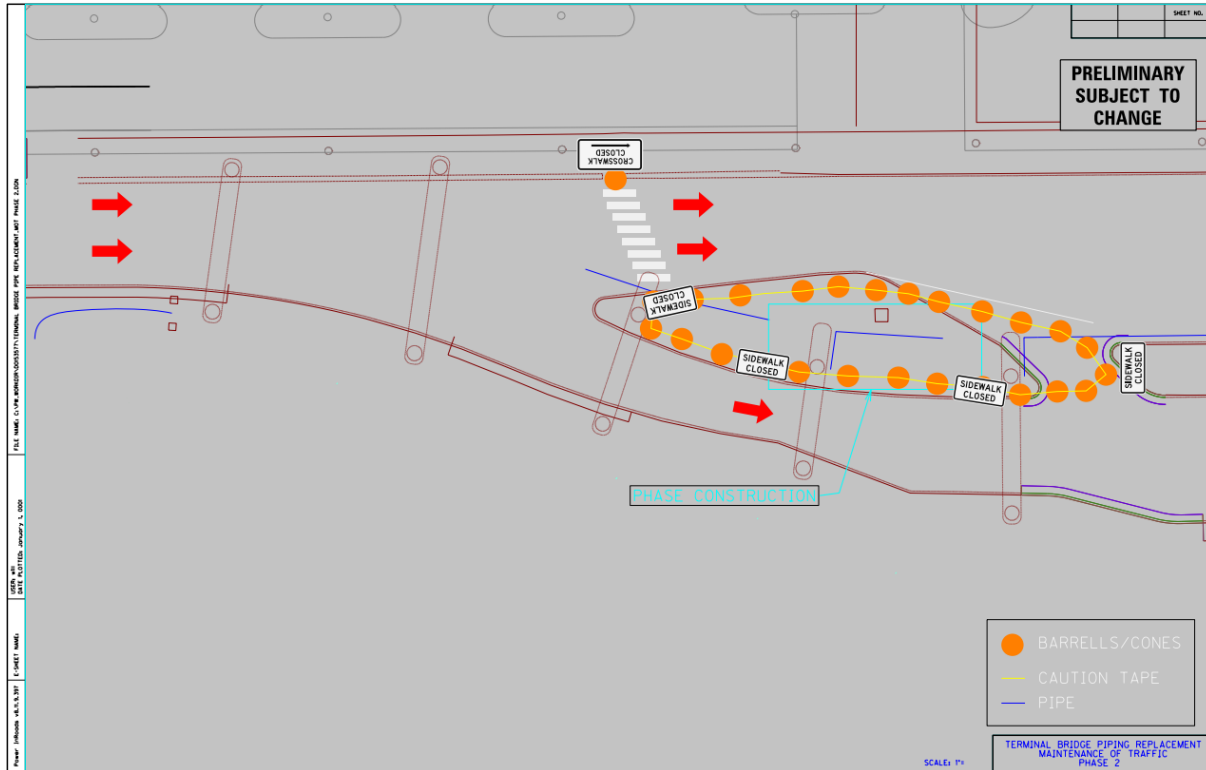

Phase 3 is scheduled to occur between 1/20/23 and 1/24/23 in the area detailed below:

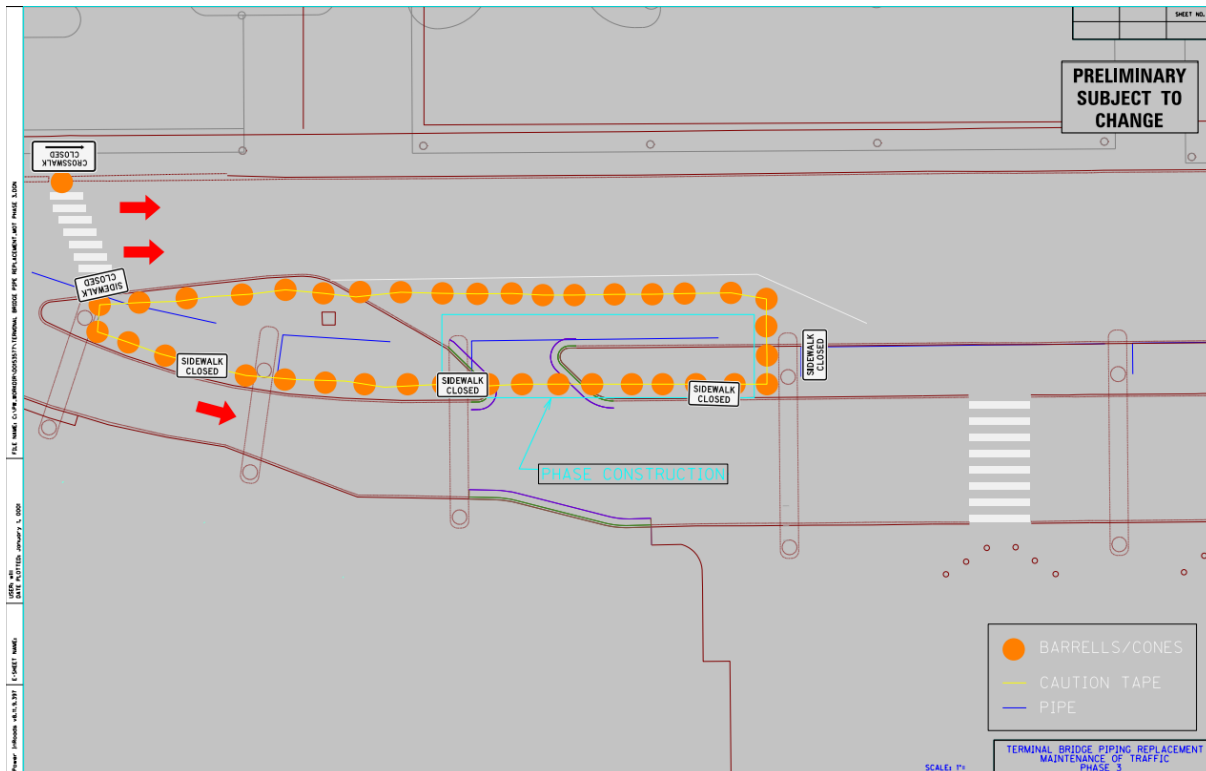

Phase 4 is scheduled to occur between 1/25/23 and 1/27/23 in the area detailed below:

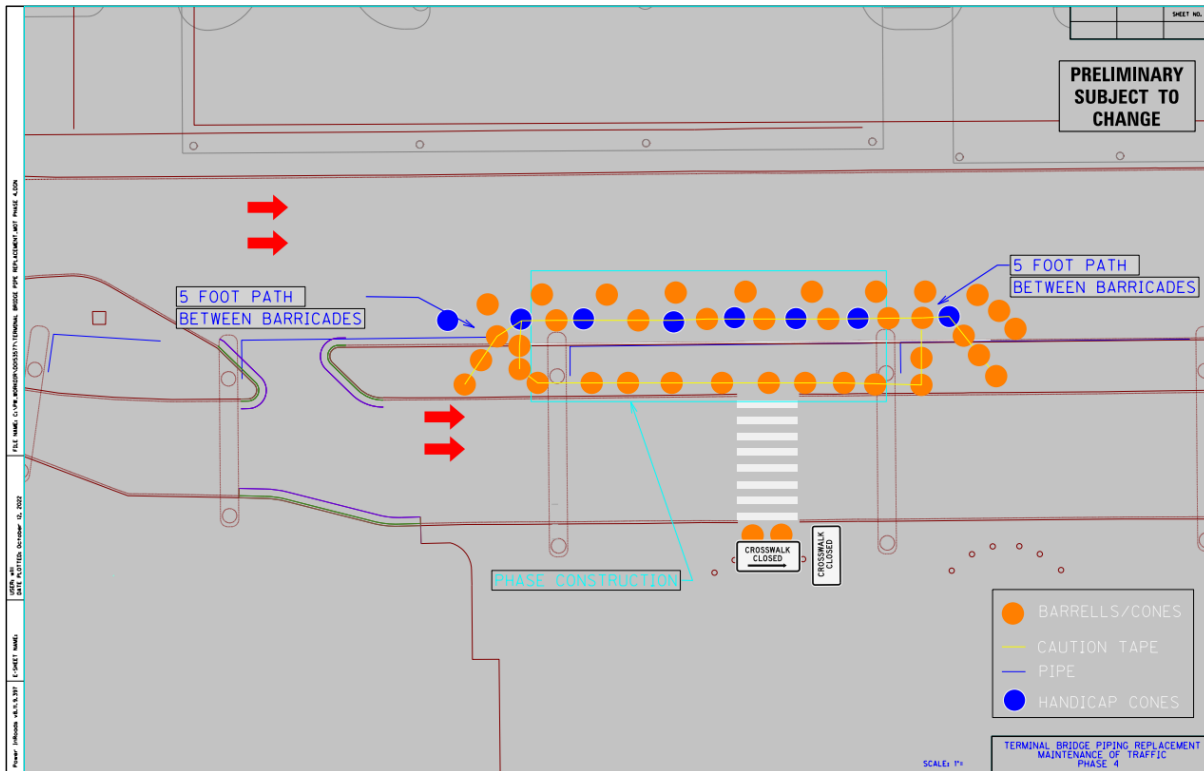

Phase 5 is scheduled to occur between 1/30/23 and 2/1/23 in the area detailed below:

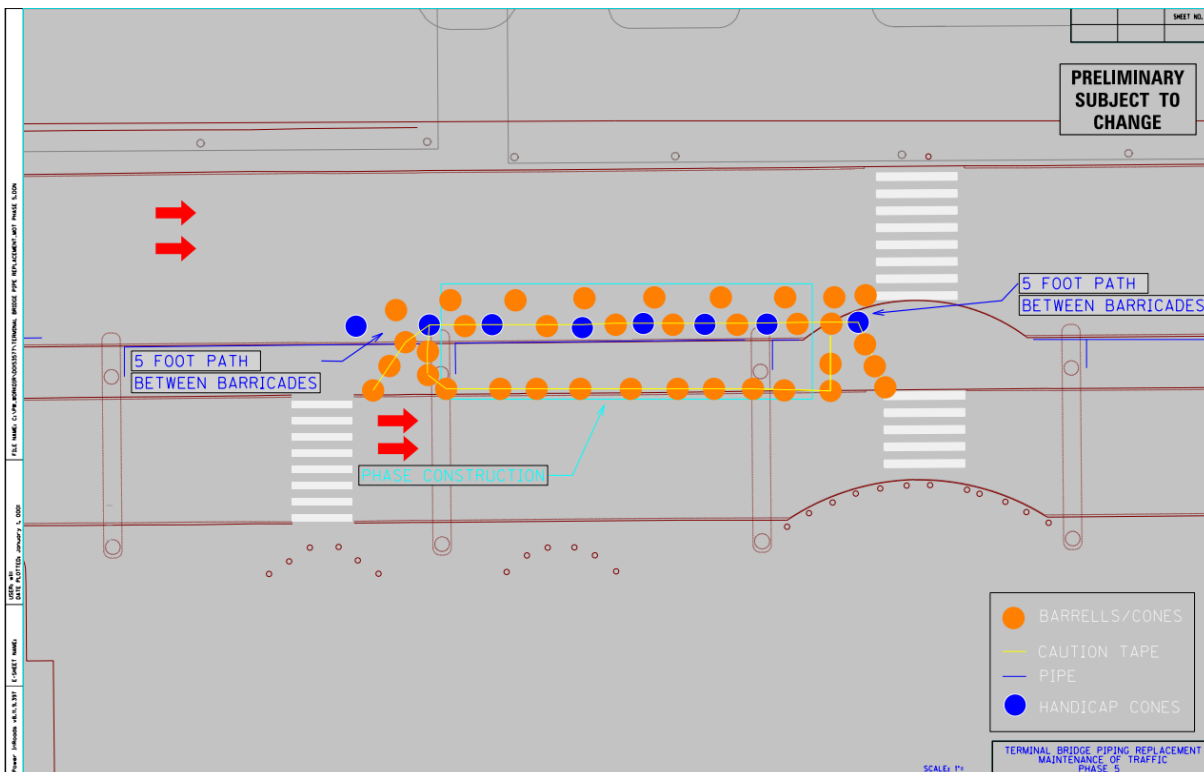

Phase 6 is scheduled to occur between 2/2/23 and 2/6/23 in the area detailed below:

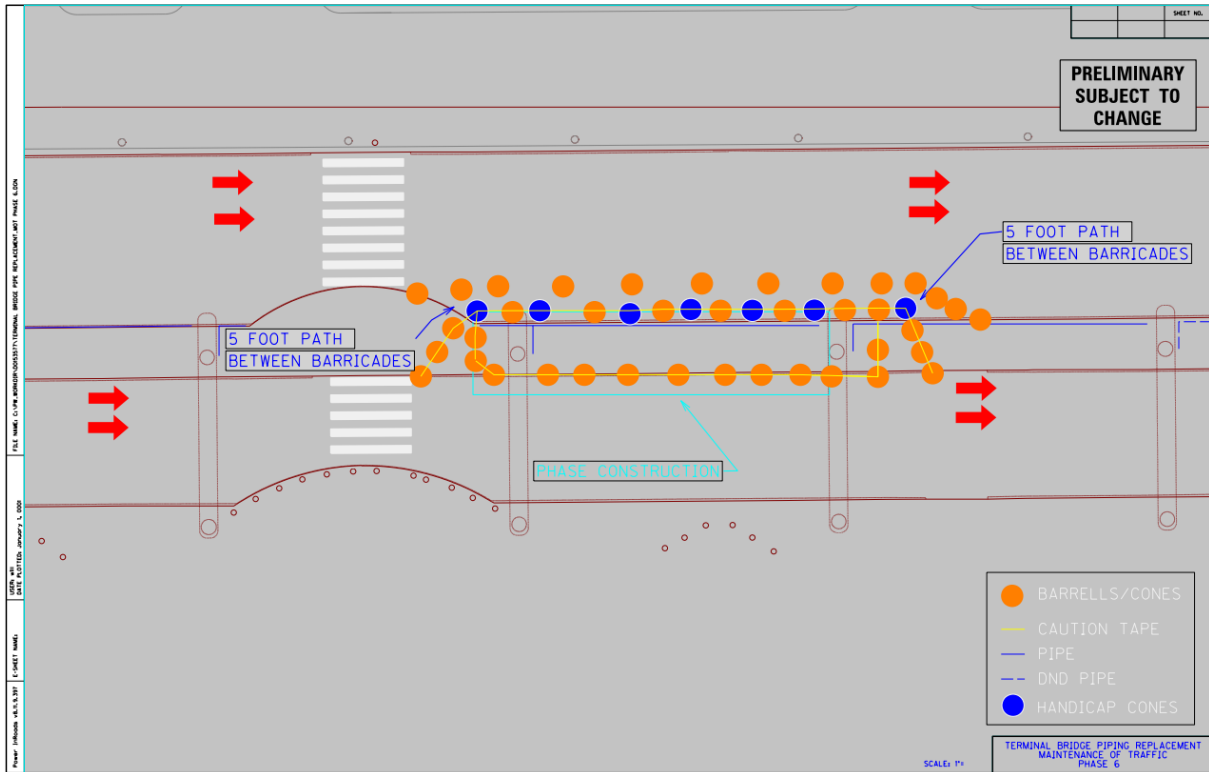

Phase 7 is scheduled to occur between 2/7/23 and 2/9/23 in the area detailed below:

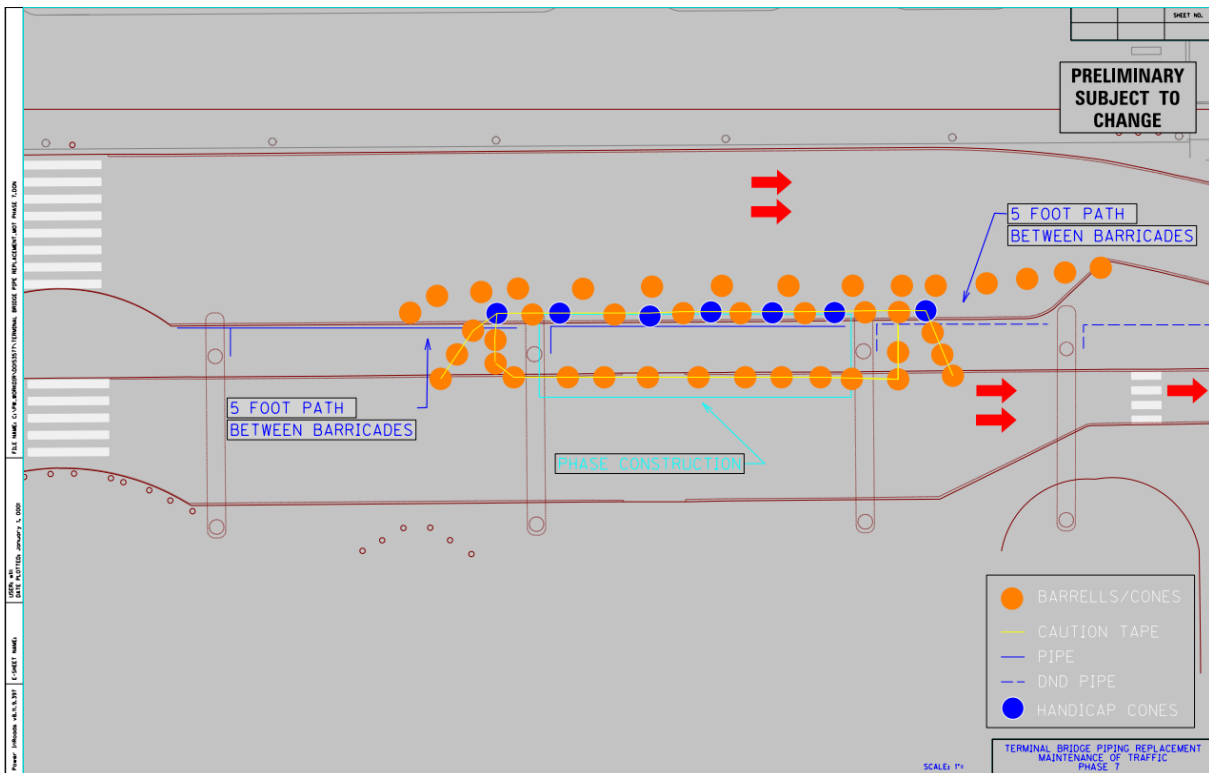

Phase 8 is scheduled to occur between 2/10/23 and 2/15/23 in the areas detailed below:

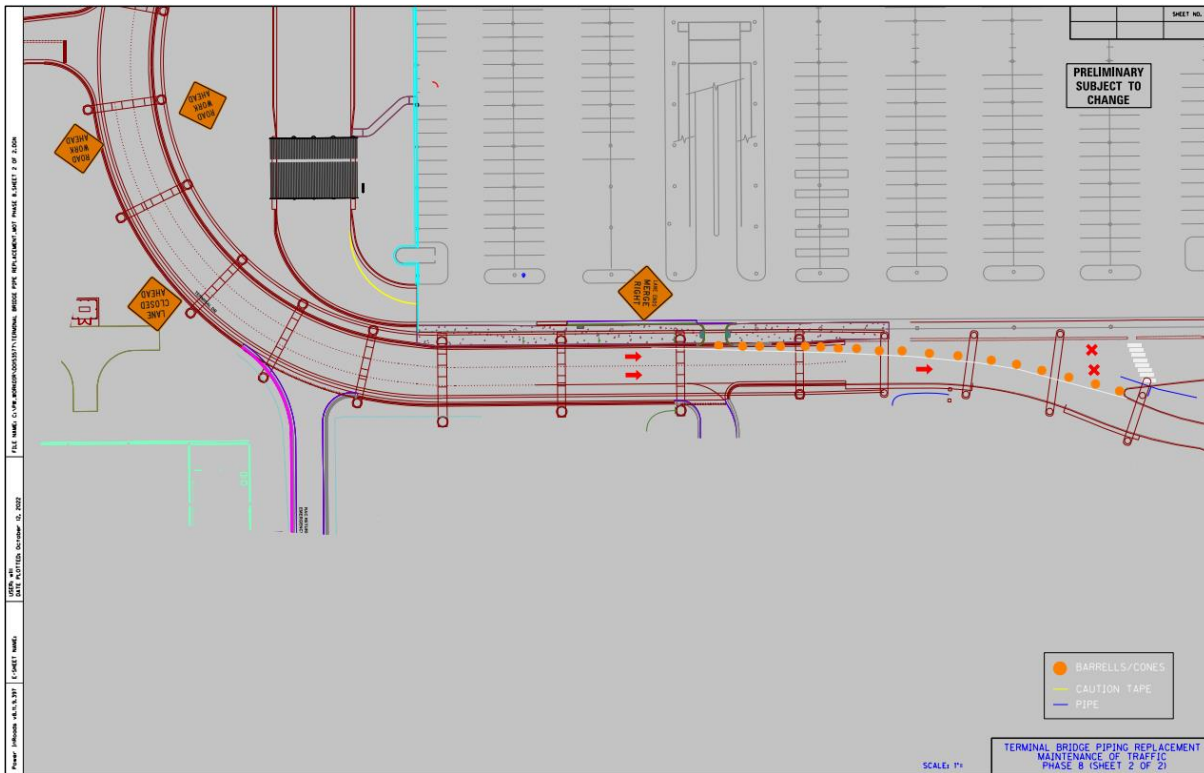
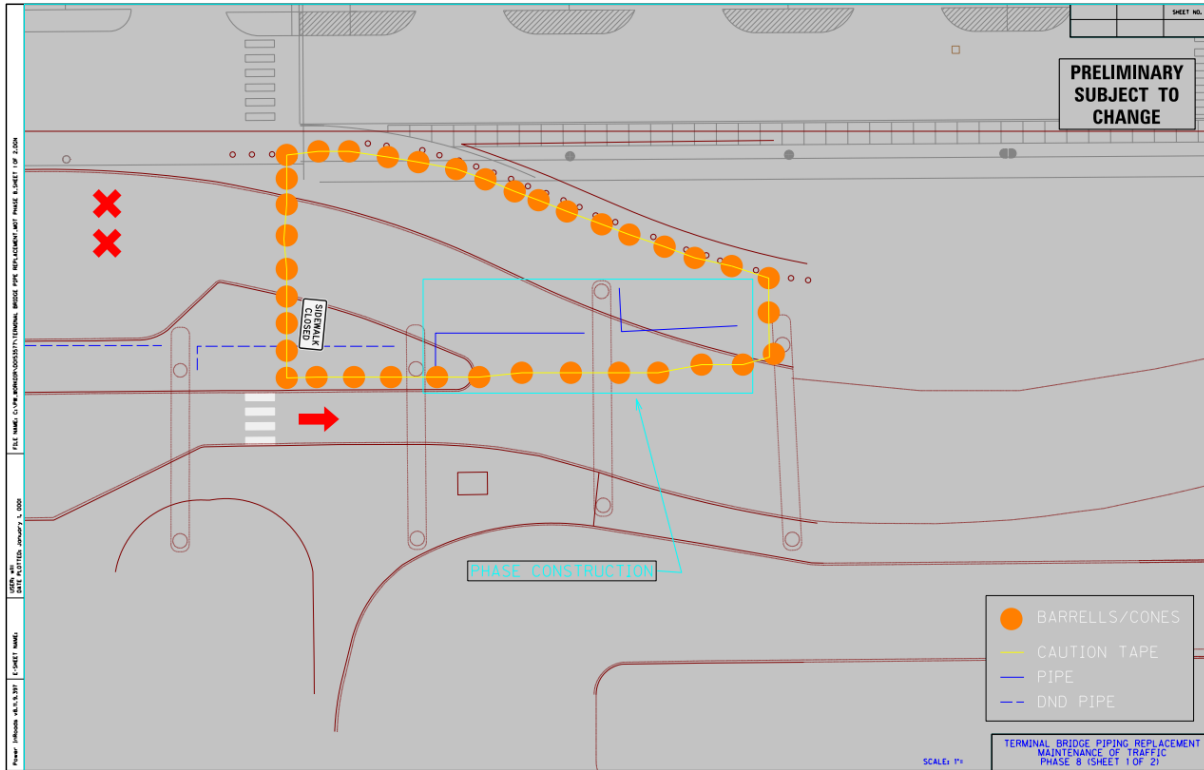

**Work in the Terminal Parking Garage is scheduled to begin on 1/31/23 and is currently scheduled to end by 1/9/24. Work has been split into Terminal 3 (3 Phases) and Terminal 2 (2 Phases).**

**Terminal 3 Work:**

- Phase 1 is scheduled to occur between 1/31/23 and 4/24/23. Rows impacted during this phase will be rows 48-56 on all levels.
- Phase 2 is scheduled to occur between 4/9/23 and 7/24/23. Rows impacted during this phase will be rows 41-48 on all levels.
- Phase 3 is scheduled to occur between 7/9/23 and 10/11/23. Rows impacted during this phase will be rows 31-41 on all levels.

**Terminal 2 Work:**

- Phase 1 is scheduled to occur between 9/27/23 and 11/29/23. Rows impacted during this phase will be rows 18-22 on levels 1-3.
- Phase 2 is scheduled to occur between 11/14/23 and 1/9/24. Rows impacted during this phase will be rows 22-28 on levels 1-3.

Please see phased areas detailed below:

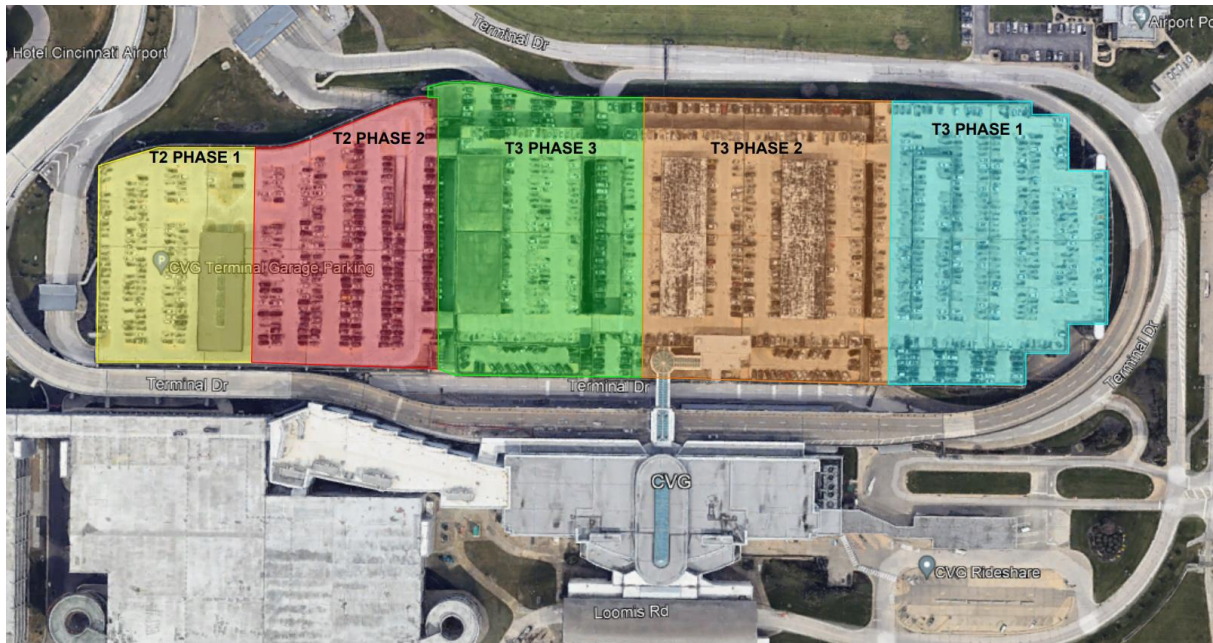

For questions or concerns regarding this project, please contact Thad Fogle with CVGAA at [tfogle@cvgairport.com](mailto:tfogle@cvgairport.com) or 859-743-5978.

Thank you for your cooperation.