



**To: CVG Airlines and Tenants**

**Subject: Concourse B – AHU Work, Tenant Relocations, and Operational Impacts**

**Date: 05/28/2025**

**Effective Tuesday June 10<sup>th</sup>, 2025 at 6:00AM**

## 1. Overview

This memorandum outlines upcoming construction activities under Phase 1 of the Elevate CVG Terminal Modernization Program (TMP), which will create space for a new consolidated bag makeup area in Concourse B. This area will eventually become part of the airport’s new Baggage Handling System (BHS).

The scope includes:

- Removal of existing air handling units (AHUs) from the basement level
- Installation of temporary cooling systems and scaffolding at the ramp and boarding levels
- Preparation for new rooftop AHUs, including structural framing and utility tie-ins

To safely complete this work, several boarding-level hold rooms and adjacent tenant spaces must be temporarily closed. These closures are solely for access to route mechanical, electrical, and plumbing (MEP) systems and install structural supports — they are not part of hold room modernization efforts.

## 2. Construction Activity Schedule

Below you will find the most up-to-date schedule based on the current timing of each activity.

**Please note that the schedule is subject to change per delays that may occur during each activity.**

Activity	Impacted Areas	Start	Finish
Delta Storage Relocation	Ramp Level – West End	06/10/2025	07/15/2025
K9 Training Area Relocation	Ramp Level – East End	06/10/2025	07/15/2025
Temporary Cooling System in Operation	Ramp Area – North Side	06/10/2025	11/21/2025
Hold Room Phase 1 Closure	<ul style="list-style-type: none"> <li>• Gate B20 Hold Room – closed</li> <li>• Gate B21 Hold Room – closed</li> <li>• Crew Outfitters – closed</li> <li>• Escape Lounge – remains open (using temp cooling/heat units)</li> </ul>	06/27/2025	07/17/2025

	Note: Gate B20 & B21 available for RON Parking during this time		
Hold Room Phase 2 Closure	<ul style="list-style-type: none"> <li>• Gate B22 Hold Room – closed</li> <li>• Gate B23 Hold Room – closed</li> <li>• Delta Break Room &amp; Offices – closed (temporary relocation)</li> <li>• USO Lounge (vacant) - closed</li> </ul> <p>Note: Gate B22 &amp; B23 available for RON Parking during this time</p>	07/21/2025	08/08/2025
Hold Room Phase 3 Closure – Rooftop Steel	B20 and Crew Outfitters (hold room and aircraft parking closed after morning push)	09/03/2025	09/23/2025
Hold Room Phase 4 Closure – Rooftop Steel	B23 and USO Lounge – vacant (hold room and aircraft parking closed after morning push)	09/24/2025	10/14/2025
Phase 5 - Set Rooftop Units (RTUs)	B20 and B23 Hold Rooms (hold room and aircraft parking closed after morning push)	10/16/2025	10/17/2025
Phase 6 - Permanent RTU tie-in and testing/commissioning	B20 and B23 Hold Rooms (hold room closed after morning push, aircraft parking stays open)	10/17/2025	11/21/2025

### 3. Delta Stores and K9 Training Area Relocation – Ramp Level

To support upcoming BHS construction, existing Delta parts storage and the K9 training facility must be relocated. This will involve:

- Demolition of unoccupied concourse spaces
- Renovation of secure facilities at the east and west ends of Concourse B
- Utility tie-ins and support spaces for operational use

Movers and logistical support will be provided to assist with equipment and furniture transfers. The ramp-level staging areas for this work will be enclosed using lighted medium-profile barricades. No airport or tenant personnel access will be permitted.

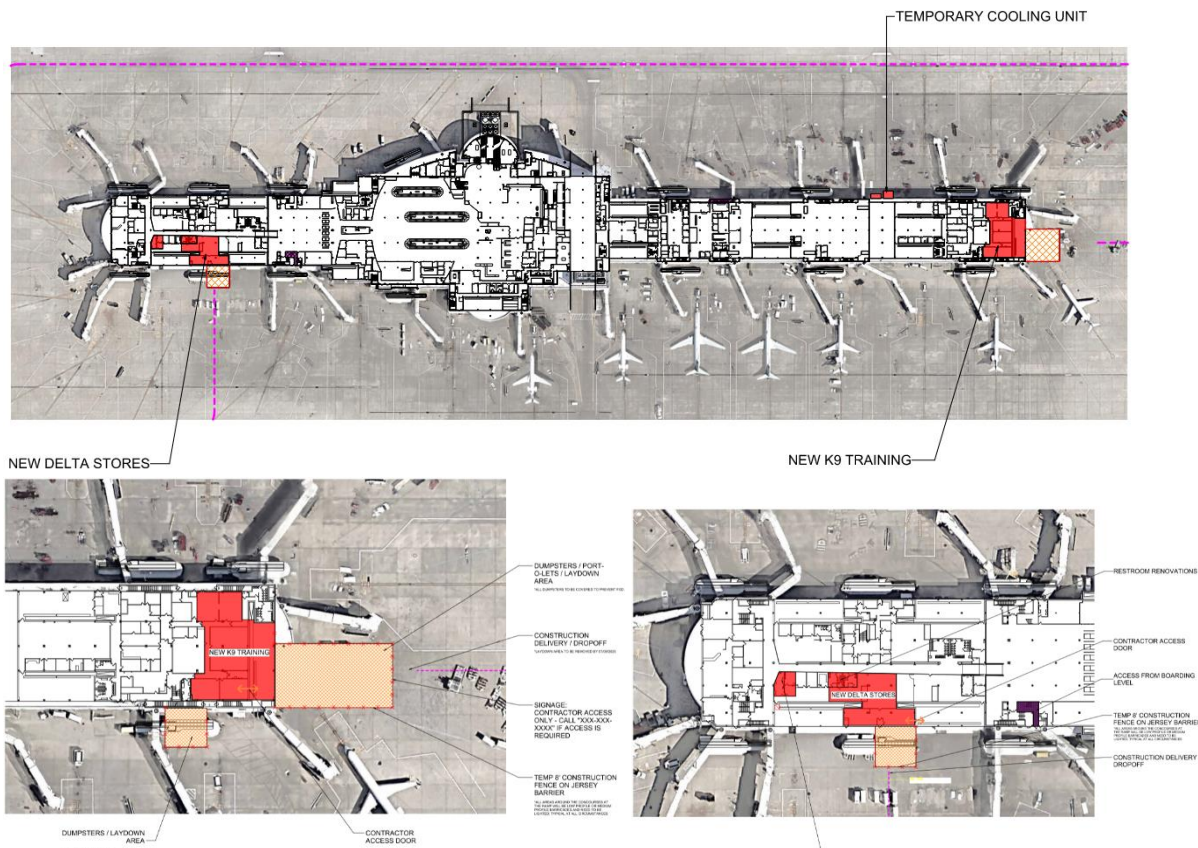

#### 4. Temporary Cooling System, Contractor Access & Deliveries – Ramp Level

##### Temporary Cooling System

To maintain climate control in affected terminal areas, a temporary AHU will be installed on the north ramp face of Concourse B, along with vertical riser support systems.

- Operational from June 10, 2025, through November 21, 2025
- Unit will be located in front of the breezeway drive-through, blocking normal vehicle path
- Temporary scaffolding, duct risers, and plumbing/electrical service will connect rooftop to basement
- Work area will be protected using lighted medium-profile barricades
- Pedestrian and vehicle traffic must avoid this zone.

##### Contractor Access & Deliveries

All contractor access and logistics will comply with CVG security and operational protocols:

- Ramp access through Gate NE-20 and vehicle service road (VSR)
- Boarding-level access via OHD Roll Door B-15
- Interior protection (e.g., carpet wrap, wall pads) will be used during material handling
- All laydown, equipment, and dumpster zones will remain within secured ramp barricades
- Escorts required for non-badged personnel and delivery drivers

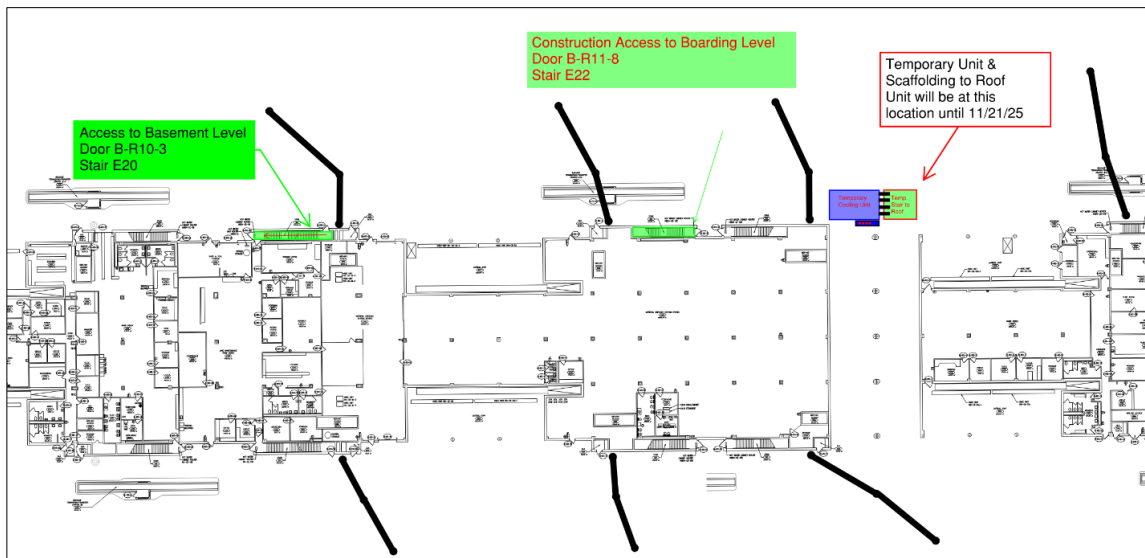

### 5. Boarding-Level Hold Room Closures

To complete vertical MEP and structural work in support of the new BHS rooftop infrastructure, temporary closures of boarding-level gates and support areas are required.

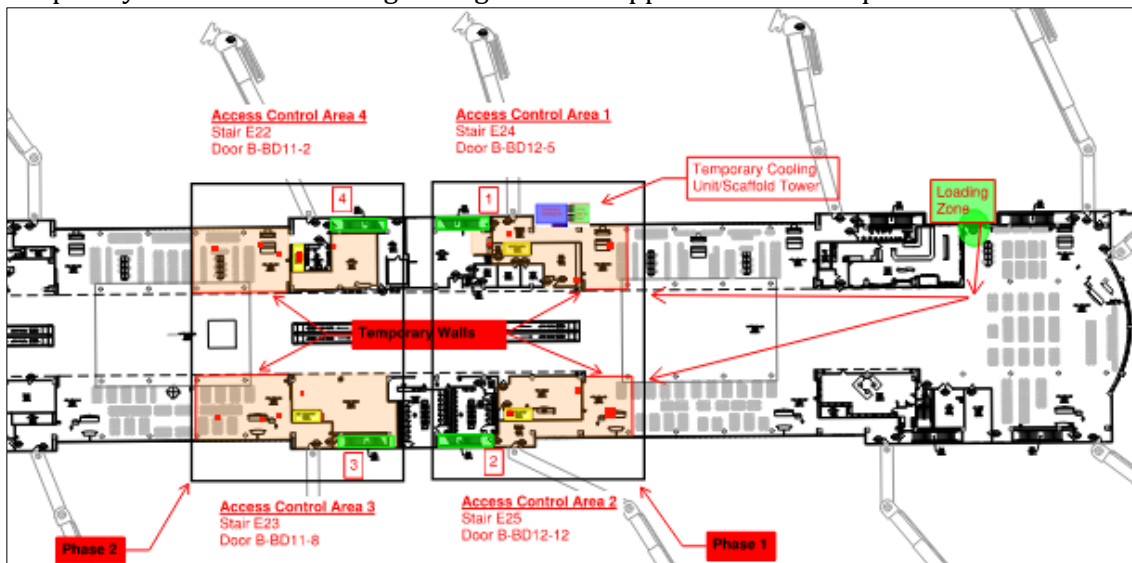

Closures of affected spaces are as follows:

#### Phase 1 Closures and Affected Areas: June 27 – July 17, 2025

- Gate B20 and Crew Outfitters
  - Gate and hold room will be closed throughout the entirety of the phase
  - Crew Outfitters will be closed throughout the entirety of the phase
  - Full-height temporary barriers will be used to close the area
- Gate B21
  - Gate and hold room will be closed throughout the entirety of the phase
  - Full-height temporary barriers will be used to close the area

- Escape Lounge (will stay open with temporary cooling)
  - Temporary cooling units will be used to service the Escape Lounge without disruption
  - The Escape Lounge remains open throughout this phase

**Phase 2 Closures: July 21 – August 8, 2025**

- Gate B22 and Delta break room/offices
  - Delta’s break room/offices will be temporarily relocated
  - Coordination with the ATR and Delta is ongoing to identify and prepare a suitable temporary location
  - Gate and hold room will be closed throughout the entirety of the phase
  - Full-height temporary barriers will be used to close the area
- Gate B23 and USO Lounge (vacant)
  - Gate and hold room will be closed throughout the entirety of the phase
  - Full-height temporary barriers will be used to close the area

**Phase 3 Closures: September 3 – September 23, 2025**

- Gate B20 closed after morning push
  - Hold room and gate will be open to accommodate morning flight schedule
  - Contractor will put up full-height temporary barriers to close the area during work hours
  - Area will reopen for following day use
  - A mobile crane will be used; aircraft parking at Gate B20 will be closed after the morning push
  - Actual downtime will be coordinated with Airport Operations and the airlines

**Phase 4 Closures: September 24 – October 14, 2025**

- Gate B23 closed after morning push
  - Hold room and gate will be open to accommodate morning flight schedule
  - Contractor will put up full-height temporary barriers to close the area during work hours
  - Area will reopen for following day use
  - A mobile crane will be used; aircraft parking at Gate B23 will be closed after the morning push
  - Actual downtime will be coordinated with Airport Operations and the airlines

**Phase 5 – Set Rooftop RTUs: October 16 – October 17, 2025**

- Gates B20 and B23 closed after morning push
  - Hold room and gate will be open to accommodate morning flight schedule
  - Contractor will put up full-height temporary barriers to close the area during work hours
  - Area will reopen for following day use
  - A mobile crane will be used; aircraft parking at Gates B20 and B23 will be closed after the morning push
  - Actual downtime will be coordinated with Airport Operations and the airlines

**Phase 6 – Permanent RTU Tie-in and Commissioning: October 17 – November 21, 2025**

- Gates B20 and B23 closed after morning push
  - Rooftops will be impacted
  - Hold room and gate will be open to accommodate morning flight schedule
  - Contractor will put up full-height temporary barriers to close the area during work hours
  - Area will reopen for following day use

Confirmed dates will be issued via future monthly Elevate CVG Operations Memos, or by additional memos as needed. Actual dates will depend on the new RTU delivery.

**6. Key Contacts**

Contact	Name	Phone	Email
Sr. Program Manager	Corinne Reynolds	859.767.1663	Creynolds@cvgairport.com
TMP Area Manager	Alonzo Allen	859.652.4510	Aallen@cvgairport.com

For general inquiries please use the Elevate CVG email address at [elevatecvg@cvgairport.com](mailto:elevatecvg@cvgairport.com).